

## 1811 CL LED Display Case Lights

Part Number: 61811 CL\*

### ⚠ CAUTION

- This product must be installed in accordance with local and national electric codes by a qualified electrician (The manufacturer assumes no responsibility for improper installation or application of this lighting fixture)
- All supply wires must be suitable for 90°C
- Turn off all electricity before installation or servicing
- This **“FIXTURE MUST BE GROUNDED”**
- Verify a secure connection at the mounting brackets
- No Serviceable Parts

### DIRECTIONS

1. Unpack fixture and remove all packaging
2. Mount fixture using supplied brackets
3. Snap fixture into place using even force
4. Attach white wire to neutral wire of supply
5. Attach black wire to power wire of supply
6. Attach green wire to ground
7. Plug in power cord and turn on breaker

#### Notes:

- MAX Feed through current = 4 AMPS
- Use through connector for optional adding/ daisy chaining of fixtures
- UL approved for use inside, Refrigerated/Non-Refrigerated Cabinets, E333932
- Damp location approved

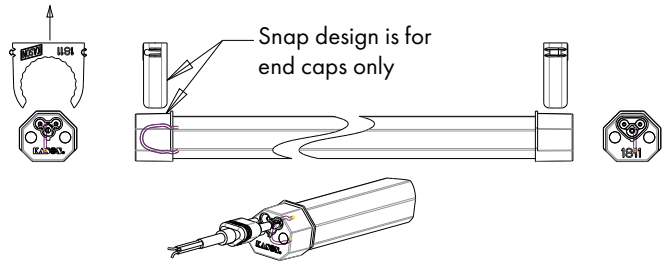

Through Connector	Connector Cap	Power Cap

Part No.	Description	AMPS @ 120 V	AMPS @ 240 V	AMPS @ 277 V	Qty./ Carton	Wgt./ Carton
61811 CL000120	LED, 12", 6 W, 120-277 V, 600 LM	0.05	0.025	0.022	25	19 lb
61811 CL000180	LED, 18", 8 W, 120-277 V, 800 LM	0.07	0.033	0.029	25	23 lb
61811 CL000240	LED, 24", 12 W, 120-227 V, 1200 LM	0.10	0.050	0.043	25	28 lb
61811 CL000360	LED, 36", 18 W, 120-227 V, 1800 LM	0.15	0.075	0.065	25	37 lb
61811 CL000480	LED, 48", 24 W, 120-227 V, 2400 LM	0.20	0.100	0.087	25	48 lb