

## 0660 Series Energy Saving Condensation Evaporators

Part Number: 10660 Series

### ⚠ WARNING

Condensate evaporators are incomplete in construction features. They are intended solely as factory-installed components of other equipment. It is the responsibility of the original equipment manufacturer to provide safeguards in the location and electrical connections for all condensate evaporator applications.

### DIRECTIONS

#### Assembly and Placement on a Horizontal Surface

1. Attach the enclosed springs onto the evaporator legs by pressing the small end of the spring onto the leg while twisting  
**WARNING!** Spring feet must be installed to elevate heater
2. Position the evaporator in a well-ventilated area to allow the moisture laden air to be carried off
3. Do not operate the evaporator on any wet surface
4. Do not place the evaporator on any wood surface or near any flammable materials
5. Do not allow power cord to make contact with the hot outside surface of pan

**Note:** Optionally, the evaporator may be mounted to a vertical surface by Kason Wall Mounting Bracket 10660000064.

#### Wiring

6. The evaporator is marked with its voltage rating. Use a separate electrical line connected to a fuse block or circuit breaker of proper capacity to assure full voltage. Voltage drops will decrease operating performance and voltage surges may damage the unit
7. Connect green center conductor to ground to ensure all units are grounded

**Note:** The unit has passed a Hi Pot test by Kason. (Hi Pot testing not required) Hi Pot over 1500 volts and 1 second will damage unit and void warranty.

#### Maintenance

8. Do not remove the enclosure covers or tamper with any components
9. Clean the pan regularly for maximum performance. Clean by brushing out loose residue with a stiff brush. For safe handling, the unit must be off when cleaning. Do not submerge unit in water

**Note:** The installer of this unit must provide the refrigeration equipment operator with any applicable instructions and warnings for its use, as installed in the equipment.

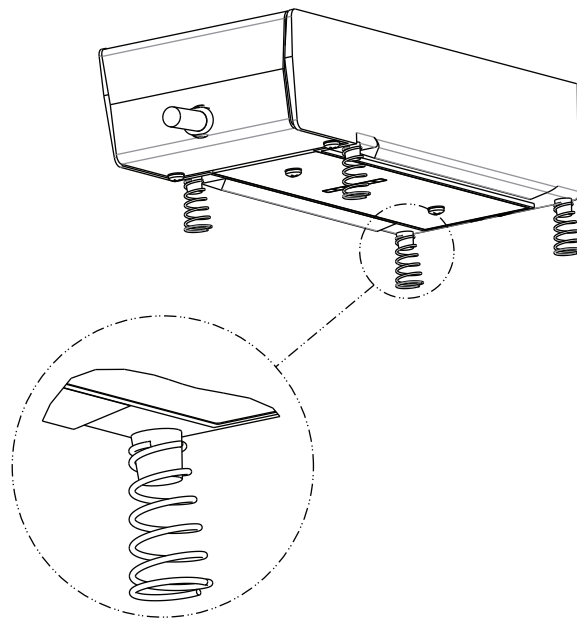

The 0660 Series Condensate Evaporators have a 50 oz. capacity.