

1908 Weatherproof Switch

Part Number: 11908*

FEATURES

- Durable Construction: Cover plate made of stainless steel over molded with premium grade silicone
- Multi-Function: Kason's innovative design integrates a single and three-way switch in one model to simplify purchasing and inventory
- Pilot Light Built in for Easy Illumination: Eliminates the need for additional components
- Flexibility: Built in indicator can be wired as "night light" or "lights on" to meet all of your needs
- Reduced installation Labor: Spade wire terminals for easy and fast installation
- Ideal solution for "wet locations", indoor and out

DESIGN CRITERIA

- Electrical Ratings
 - 20 amp @120 VAC General Use
 - 5 amp @125 VAC Tungsten
 - 5 amp @250 VAC Ballasted
 - 4.9 amp @ 125 VAC Electronic Ballast
- 1908-603 - Single and Three-Way Switch with Indicator Light
 - Indicator: Neon
 - Circuit: SPDT + Indicator
 - Approvals: UL Recognized and NSF Component
 - Connection: 1/4" Spade male terminal
- 1908-604 -Four-Way Switch with Indicator Light
 - Indicator: Neon
 - Circuit: DPDT + Indicator
 - Approvals: UL Recognized and NSF Component
 - Connection: 1/4" Spade male terminal

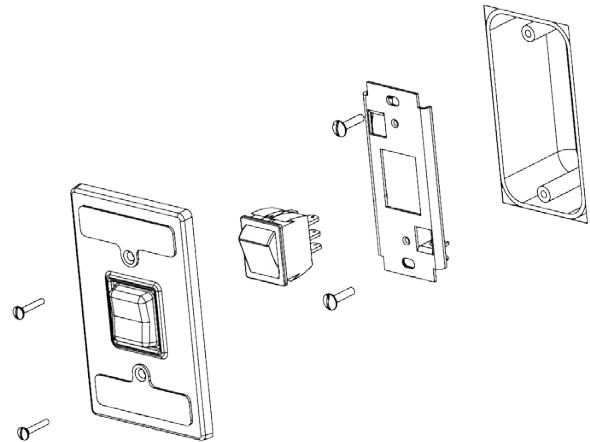

| *Part No. | Description |
|--------------|---|
| 11908000602 | Weatherproof Rocker Cover |
| 11908000603 | Weatherproof Rocker Switch, Single or 3-Way |
| 11908000604 | Weatherproof Rocker Switch, 4-Way |
| 3ELE0000104† | 2-1/8" Deep Junction Box |

†Sold Separately